

Bulkhead coupler

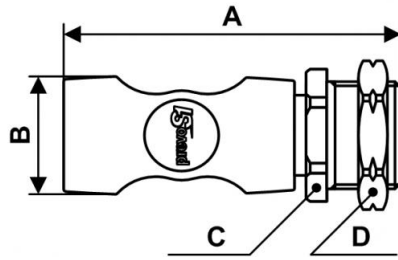

<p><u>BSPF female thread</u></p> <p>G 1/2</p>	<p><u>Panel depth (mm)</u></p> <p>11</p>	<p><u>ID Passage (mm)</u></p> <p>27</p>	<p><u>Technology</u></p> <p>"One push" safety system (avoids hose whip)</p>
<p><u>Operating pressure</u></p> <p>2 to 12 bar</p>	<p><u>Flow rate at 6 bar</u></p> <p>2028 l/min ($\Delta P = 0,6$ bar)</p>	<p><u>ID Passage</u></p> <p>8 mm</p>	<p><u>Temperature</u></p> <p>-15°C to +70°C</p>
<p><u>Construction</u></p> <p>Composite body</p>	<p><u>Highlight</u></p> <p>Anti-static Non scratch</p>		

Description			
Reference	BSPF female thread	Panel depth (mm)	ID Passage (mm)
ISI 082103	G 1/2	11	27



Dimensions

Reference	A mm	B mm	C mm	D mm
ISI 082103	96.9	33	29	32