

Parallel male thread adaptor



BSPB male thread

G 3/8

ID Passage

11 mm

Construction

Stainless steel

Description

| Reference | BSPB male thread |
|-------------------|------------------|
| CRP 116152 | G 3/8 |
| CRP 116153 | G 1/2 |
| CRP 116154 | G 3/4 |

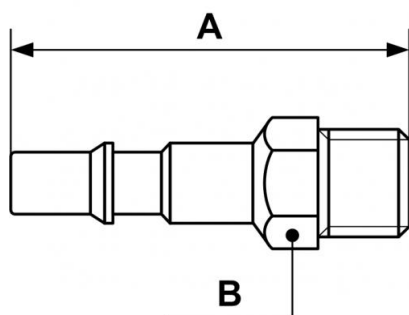

Dimensions

| Reference | A mm | B mm |
|-------------------|------|------|
| CRP 116152 | 64 | 24 |
| CRP 116153 | 65 | 24 |
| CRP 116154 | 69 | 32 |