

Parallel female thread coupler



BSPP female thread

G 1/4

Profile

British

Technology

"One push" safety system
(avoids hose whip)

Operating pressure

2 to 12 bar

Flow rate at 6 bar

750 l/min ($\Delta P = 0,6$ bar)

ID Passage

6 mm

Temperature

-15°C to +70°C

Construction

Composite body

Highlight

Anti-static Non scratch

Description

Reference	BSPP female thread
BSI 061101	G 1/4
BSI 061102	G 3/8
BSI 061103	G 1/2

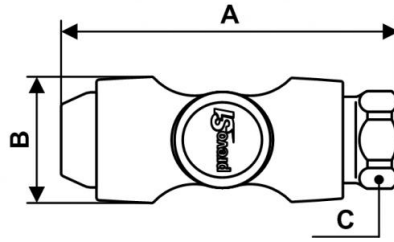

Dimensions

Reference	A mm	B mm	C mm
BSI 061101	76.2	30	20
BSI 061102	81.6	30	20
BSI 061103	87.7	30	26