

Parallel male thread coupler



BSPB male thread

G 1/4

Technology

"One push" safety system
(avoids hose whip)

Operating pressure

2 to 12 bar

Flow rate at 6 bar

800 l/min ($\Delta P = 0,6$ bar)

ID Passage

6 mm

Temperature

-15°C to +70°C

Construction

Composite body

Highlight

Anti-static Non scratch

Description

Reference

BSPB male thread

ASI 061151

G 1/4

ASI 061152

G 3/8

ASI 061153

G 1/2

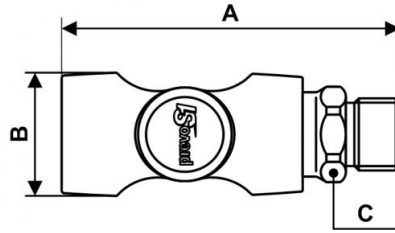

Dimensions

Reference	A mm	B mm	C mm
ASI 061151	76.3	30	20
ASI 061152	78.3	30	23
ASI 061153	82.3	30	26