

## Bulkhead coupler



### BSPB male thread

G 1/4

### Drill Ø (mm)

27

### Panel depth (mm)

11

### Technology

"One push" safety system  
(avoids hose whip)

### Operating pressure

2 to 12 bar

### Flow rate at 6 bar

800 l/min ( $\Delta P = 0,6$  bar)

### ID Passage

6 mm

### Temperature

-15°C to +70°C

### Construction

Composite body

### Highlight

Anti-static Non scratch

## Description

Reference	BSPB male thread	Drill Ø (mm)	Panel depth (mm)
<b>ASI 062101</b>	G 1/4	27	11

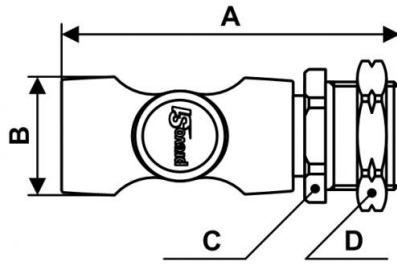

### Dimensions

Reference	A mm	B mm	C mm	D mm
<b>ASI 062101</b>	84	30	29	32