

## Hose tail coupler

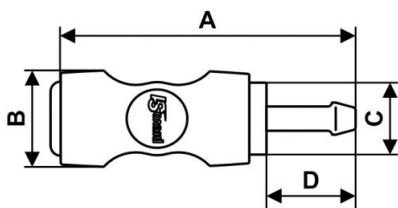

<p><b>For hose ID (mm)</b></p> <p>13</p>	<p><b>Technology</b></p> <p>"One push" safety system (avoids hose whip)</p>	<p><b>Operating pressure</b></p> <p>2 to 12 bar</p>	<p><b>Flow rate at 6 bar</b></p> <p>2028 l/min (<math>\Delta P = 0,6</math> bar)</p>
<p><b>ID Passage</b></p> <p>8 mm</p>	<p><b>Temperature</b></p> <p>-15°C to +70°C</p>	<p><b>Construction</b></p> <p>Composite body</p>	<p><b>Highlight</b></p> <p>Anti-static Non scratch</p>

Description	
Reference	For hose ID (mm)
<b>USI 081813</b>	13



### Dimensions

Reference	A mm	B mm	C mm
<b>USI 081813</b>	102.9	33	22.6