

Parallel female thread coupler



BSPP female thread

G 1/4

Technology

"One push" safety system
(avoids hose whip)

Operating pressure

2 to 12 bar

Flow rate at 6 bar

833 l/min (ΔP : 0,6 bar)

ID Passage

6 mm

Temperature

-15°C to +70°C

Construction

Composite body

Highlight

Anti-static Non scratch

Description

Reference

BSPP female thread

CSI 061101

G 1/4

CSI 061102

G 3/8

CSI 061103

G 1/2

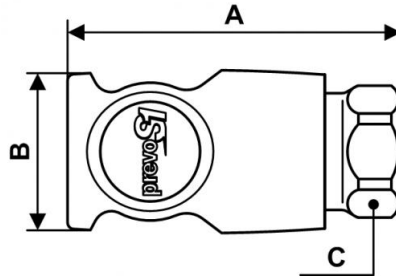

Dimensions

Reference	A mm	B mm	C mm
CSI 061101	55	27	20
CSI 061102	60.5	27	20
CSI 061103	66.5	27	26