

Parallel Female thread coupler



BSPP female thread

G 1/4

Technology

"One push" safety system
(avoids hose whip)

Operating pressure

2 to 12 bar

Flow rate at 6 bar

2028 l/min ($\Delta P = 0,6$ bar)

ID Passage

8 mm

Temperature

-15°C to +70°C

Construction

Composite body

Highlight

Anti-static Non scratch

Description

Reference

BSPP female thread

CSI 081101

G 1/4

CSI 081102

G 3/8

CSI 081103

G 1/2

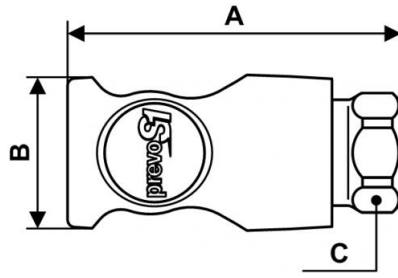

Dimensions

Reference	A mm	B mm	C mm
CSI 081101	67.5	32	23
CSI 081102	67.5	32	23
CSI 081103	75.5	32	26