

## Bulkhead coupler

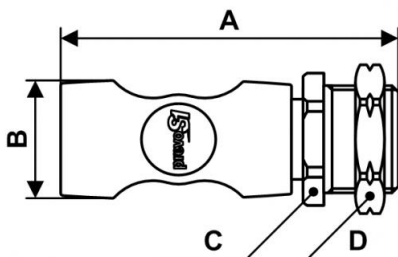

<p><b><u>BSPF female thread</u></b> G 1/4</p>	<p><b><u>Drill Ø (mm)</u></b> 27</p>	<p><b><u>Panel depth (mm)</u></b> 11</p>	<p><b><u>Technology</u></b> "One push" safety system (avoids hose whip)</p>
<p><b><u>Operating pressure</u></b> 2 to 12 bar</p>	<p><b><u>Flow rate at 6 bar</u></b> 2028 l/min (<math>\Delta P = 0,6</math> bar)</p>	<p><b><u>ID Passage</u></b> 8 mm</p>	<p><b><u>Temperature</u></b> -15°C to +70°C</p>
<p><b><u>Construction</u></b> Composite body</p>	<p><b><u>Highlight</u></b> Anti-static Non scratch</p>		

Description			
Reference	BSPF female thread	Drill Ø (mm)	Panel depth (mm)
<b>CSI 082103</b>	G 1/4	27	11



### Dimensions

Reference	A mm	B mm	C mm	D mm
<b>CSI 082103</b>	82	32	29	32