

Parallel female thread coupler - Stainless Steel



BSPP female thread

G 1/4

Technology

"One push" safety system
(avoids hose whip)

Operating pressure

2 to 12 bar

Flow rate at 6 bar

1 820 l/min ($\Delta P = 0,6$ bar)

ID Passage

7,4 mm

Temperature

-15°C to +70°C

Construction

Composite body Stainless
steel valve

Applications

Corrosive atmospheres

Highlight

Anti-static Non scratch

Description

Reference

BSPP female thread

ESI 071101HE

G 1/4

ESI 071102HE

G 3/8

Reference	BSPP female thread
ESI 071103HE	G 1/2

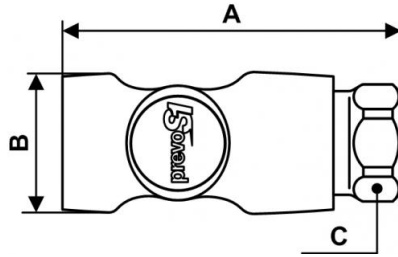

Dimensions

Reference	A mm	B mm	C mm
ESI 071101HE	73.3	32.2	23
ESI 071102HE	73.3	32.2	26
ESI 071103HE	80.3	32.2	26