

Parallel male thread coupler - Stainless Steel



BSPB male thread

G 1/4

Technology

"One push" safety system
(avoids hose whip)

Operating pressure

2 to 12 bar

Flow rate at 6 bar

1 820 l/min ($\Delta P = 0,6$ bar)

ID Passage

7,4 mm

Temperature

-15°C to +70°C

Construction

Composite body Stainless
steel valve

Applications

Corrosive atmospheres

Highlight

Anti-static Non scratch

Description

Reference

BSPB male thread

ESI 071151HE

G 1/4

ESI 071152HE

G 3/8

Reference	BSPP male thread
ESI 071153HE	G 1/2

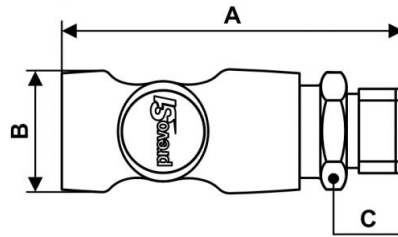

Dimensions

Reference	A mm	B mm	C mm
ESI 071151HE	81.3	32.2	23
ESI 071152HE	82.3	32.2	26
ESI 071153HE	84.3	32.2	26