

Quick-release claw - Hose tail



For hose ID (mm)

7

Max operating

pressure

10 bar

Temperature

-5°C to +60°C

Construction

Brass body

Description

| Reference | For hose ID (mm) |
|-----------|------------------|
| EXP 7 | 7 |
| EXP 8 | 8 |
| EXP 9 | 9 |
| EXP 10 | 10 |
| EXP 11 | 11 |
| EXP 13 | 13 |
| EXP 16 | 16 |
| EXP 19 | 19 |

| Reference | For hose ID (mm) |
|---------------|------------------|
| EXP 22 | 22 |
| EXP 25 | 25 |

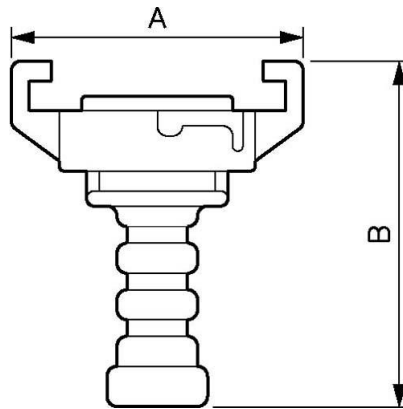

Dimensions

| Reference | A mm | B mm |
|---------------|------|------|
| EXP 7 | 57 | 69 |
| EXP 8 | 57 | 69 |
| EXP 9 | 57 | 69 |
| EXP 10 | 57 | 69 |
| EXP 11 | 57 | 69 |
| EXP 13 | 57 | 69 |
| EXP 16 | 57 | 69 |
| EXP 19 | 57 | 69 |
| EXP 22 | 57 | 69 |
| EXP 25 | 57 | 69 |